

5/2-Way, Hand Lever Manually Actuated Valve Thread-G1/8

HLV310-S Single

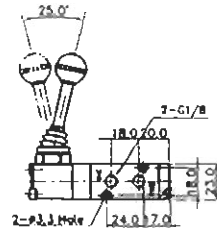

HLV320-D Double

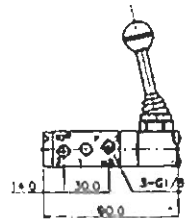
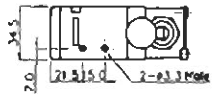
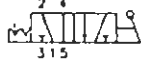

5/3-Way, Hand Lever Manually Actuated Valve Thread-G1/8

HLV330-S Closed Center

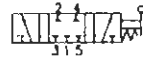

HLV330-D Closed Center

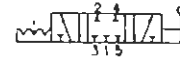

HLV340-S Exhaust Center

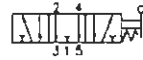

HLV340-D Exhaust Center



HLV350-S Pressure Center

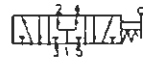

HLV350-D Pressure Center

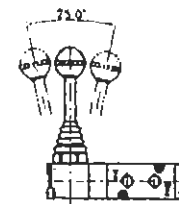
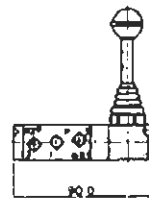

5/2-Way, Hand Lever Manually Actuated Valve Thread-G1/4

HLV410-S Single



HLV420-D Double

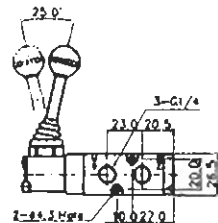
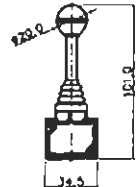
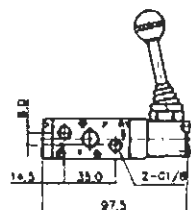
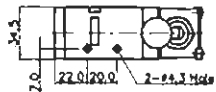

5/3-Way, Hand Lever Manually Actuated Valve Thread-G1/4

HLV430-S Closed Center

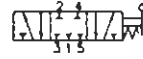

HLV430-D Closed Center



HLV440-S Exhaust Center



HLV440-D Exhaust Center



HLV450-S Pressure Center

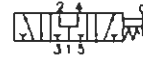

HLV450-D Pressure Center

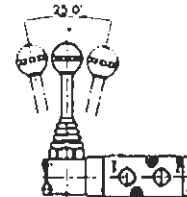
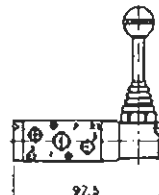

3/2-Way, Hand Lever Manually Actuated Valve Thread-G1/4

HLV460-S Single

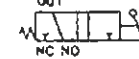

HLV460-D Double

